

MERLEWOOD ACCESS STATEMENT

Access Statement for Merlewood Holiday Apartments

Introduction

Merlewood is a Victorian stone-faced villa in a quiet residential area of St. Annes, only 100 metres from the sea front and town centre. Ground floor accommodation is available for people with limited mobility. We have made every effort to maintain the characteristics and historical features of the property. Bearing this in mind, the property is not suitable for wheelchair use.

Pre- Arrival

- ❑ We have an extensive website with photographs of the rooms.
- ❑ Bookings and enquiries can be made via telephone or by letter.
- ❑ This access statement is available on our website and upon request.
- ❑ St. Annes on Sea Railway Station is 500 metres away.
- ❑ The taxi rank is adjacent to the Railway Station.
- ❑ Bus stops for both Lytham and Blackpool are directly opposite the property.

Arrival & Car Parking Facilities

- ❑ Merlewood has private parking within its grounds, to the side of the property. The car park is lit at night.
- ❑ Space for one vehicle is available to each apartment.
- ❑ There is direct access from the car park to the front door, via a tarmac path through the front garden area.

Outdoor Facilities

- ❑ To the front of the house there is a patio area with cushioned bench seating and table.
- ❑ The patio is accessed by a shallow step of 11cm high.
- ❑ The extensive lawn slopes gently to a height 6cm above the level of the path.

Main Entrance & Reception

- ❑ The only entrance is the door to the front of the property. The key for this door is issued to our guests upon arrival.
- ❑ There are 5 steps to the front door, each measuring 13 cm high, making it unsuitable for wheelchair access.
- ❑ The front door opens into a spacious central Hall area.
- ❑ There is access from the Hall to the ground floor apartment.
- ❑ A staircase provides access to the remaining three apartments.

Porritt Apartment (Ground Floor)

- ❑ This self contained apartment is all on the same level as the Hall making it suitable for people with limited mobility.
- ❑ All rooms in the apartment are carpeted.
- ❑ There are no steps within the apartment.
- ❑ The apartment door opens into a narrow Hallway.
- ❑ There is access from this hallway into a Lounge, Kitchen, Bathroom and Bedroom.

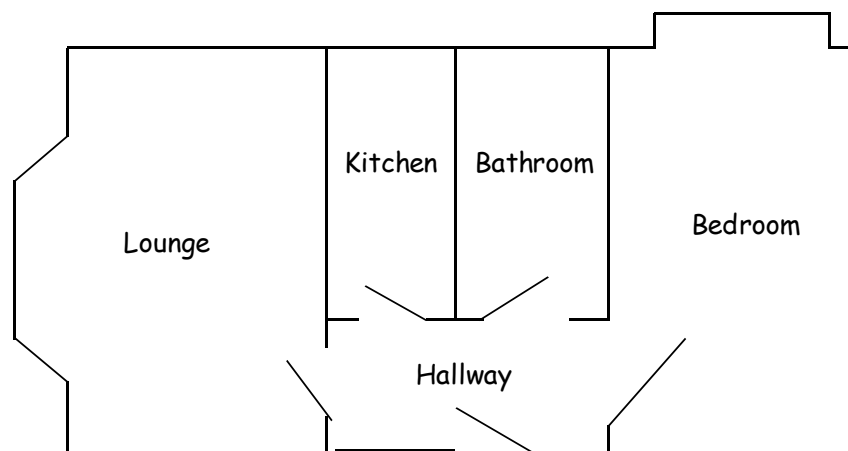

- ❑ The bedroom contains one 4'6" bed and one 3' bed.
- ❑ All bedding is cotton with non feather pillows and duvet.
- ❑ An electric 54 cm high.
- ❑ The bath has hand grips on either side.

Clifton Apartment (First Floor)

- ❑ Clifton apartment is located on the first floor landing.
- ❑ It is accessed by 20 stairs measuring 16 cm high. The stairs have a handrail.
- ❑ All rooms in the apartment are carpeted.
- ❑ There are no steps within the apartment.
- ❑ The apartment door opens into a narrow hallway.
- ❑ There is access from this hallway into a Lounge, Kitchen, Bathroom and two Bedrooms.

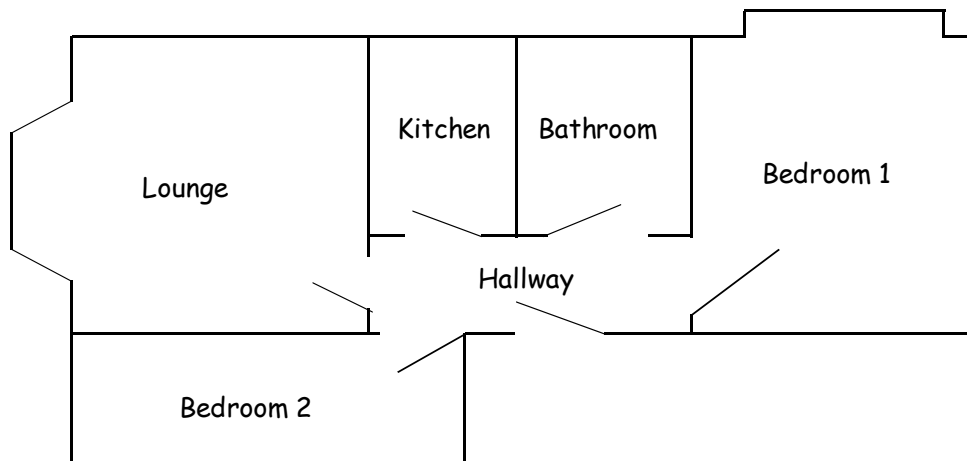

- ❑ Bedroom 1 contains one 4'6" bed and one 3' bed.
- ❑ Bedroom 2 contains two 3' beds.
- ❑ All bedding is cotton with non feather pillows and duvet.
- ❑ An electric shower is available over the bath.
- ❑ The bath side is 55 cm high.

Ansdell Apartment (Second Floor)

- ❑ Ansdell apartment is located on the second floor landing.
- ❑ It is accessed by 34 stairs measuring 16 cm high, with a handrail.
- ❑ All rooms in the apartment are carpeted.
- ❑ There are no steps within the apartment.
- ❑ The apartment door opens into the Kitchen.
- ❑ There is access from the kitchen into the Lounge and Bedroom 1. A small hallway off the kitchen provides access to the Bathroom and Bedroom 2.

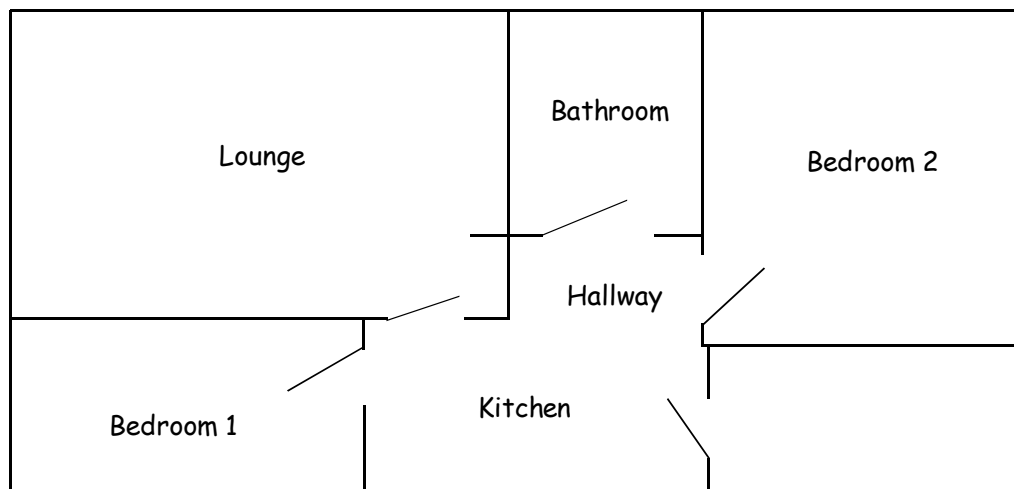

- ❑ Bedroom 1 contains one one 3' bed.
- ❑ Bedroom 2 contains one 4'6" bed and one 3' bed.
- ❑ All bedding is cotton with non feather pillows and duvet.
- ❑ An electric shower is available over the bath.
- ❑ The bath side is 54 cm high.
- ❑ The bath has hand grips on either side.

Additional Information

- ❑ A Welcome Pack is produced containing information about local amenities and maps plus a separate folder of places of interest around Lancashire.
- ❑ Merlewood does not take pets.
- ❑ The premises are Non Smoking.

Contact Information

- **Address:** Merlewood Holiday Apartments, 383 Clifton Drive North, St. Annes on Sea, Lancashire FY8 2PA
- **Telephone:** 01253 726082
- **Website:** www.merlewoodapartments.co.uk

Future Plans

- **Install handrail by front door steps.**